

# Space Management

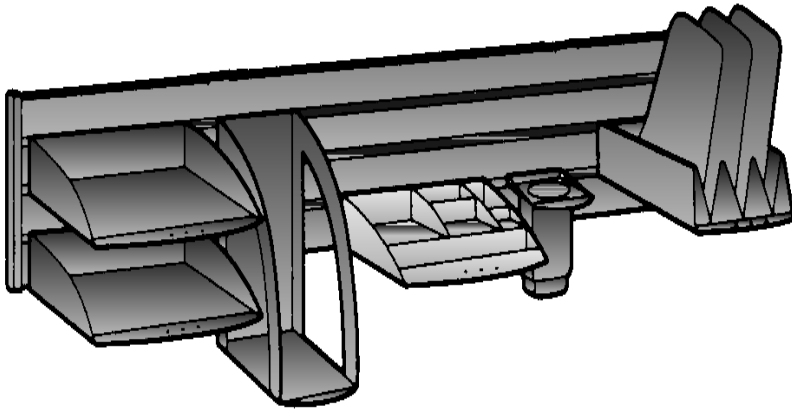

See us on the Web at: [KempHardware.com](http://KempHardware.com)

## Above the Desk Space Management



Custom Accents Space Management is designed to create added workspace for the office environment. By placing often used desk items in easy to access storage components, the user increases surface workspace and improves efficiency.

Typical applications include health care facilities, reception areas, modular work stations commercial and home offices - anywhere vertical storage is needed to create added workspace.

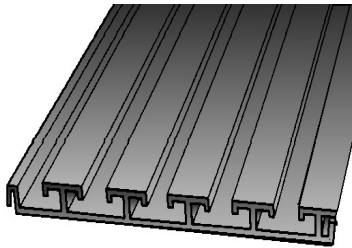

Original Tool Bar

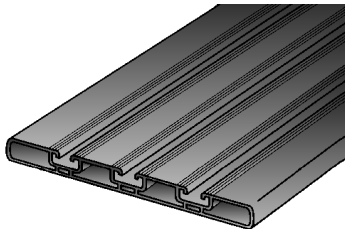

Tubular Tool Bar

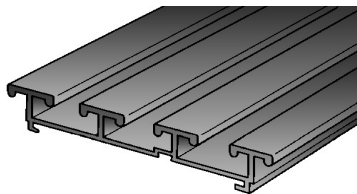

Metal Toolbar

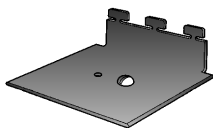

Mounting Bracket

## Tool Bars

Select the tool bar best suited to your needs. The Original Tool Bar is the most economical. The Metal Tool Bar is the strongest. The Tubular is a medium ground between the two. All are of the highest quality.

Description	Color	Part Number
36" Original Toolbar	Black	851 71136 08
48" Original Toolbar	Black	851 71148 08
72" Original Toolbar	Black	851 71172 08
24" Tubular Toolbar	Black	851 71536 08
36" Tubular Toolbar	Black	851 71536 08
48" Tubular Toolbar	Black	851 71548 08
72" Tubular Toolbar	Black	851 71572 08
36" Extruded Aluminum Toolbar	Black	851 71536 08
48" Extruded Aluminum Toolbar	Black	851 71548 08
72" Extruded Aluminum Toolbar	Black	851 71572 08
Mounting Bracket for Aluminum Bar	Black	851 72000 08

## Above the Desk Space Management Accessories



Cup Holder

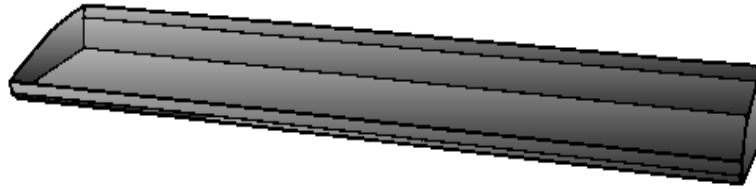

Folder Sorter

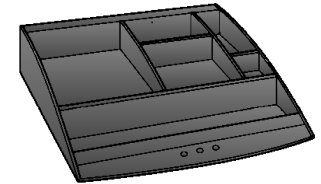

Accessory Tray

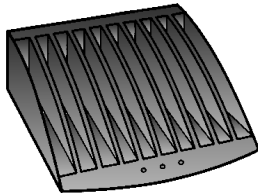

CD Holder

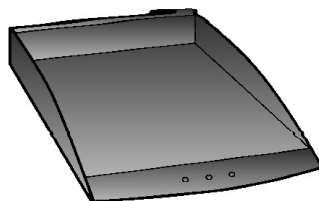

Paper Tray

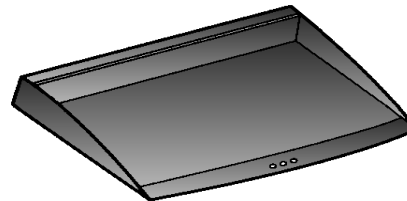

Legal Paper Tray

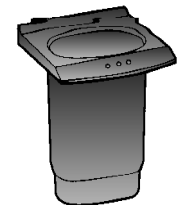

Pencil Holder

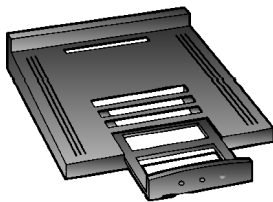

Phone Holder

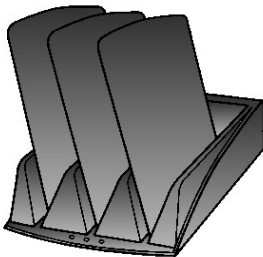

Folder Sorter

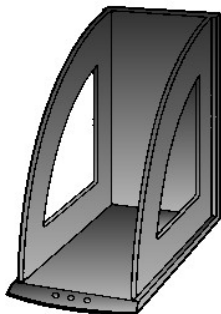

Binder Holder

## Space Management Accessories

Description	Color	Weight Load	Part Number
Accessory Tray	Black	5 lbs.	851 81004 08
Letter Size Paper Tray	Black	5 lbs.	851 81003 08
Legal Size Paper Tray	Black	5 lbs.	851 81007 08
Binder Holder	Black	10 lbs.	851 81009 08
Folder Sorter Tray	Black	10 lbs.	851 81008 08
18" Shelf with Brackets	Black	15 lbs.	851 81118 08
24" Shelf with Brackets	Black	15 lbs.	851 81124 08
30" Shelf with Brackets	Black	15 lbs.	851 81130 08
36" Shelf with Brackets	Black	15 lbs.	851 81136 08
CD Holder	Black	4 lbs.	851 81001 08
Cup Holder	Black	4 lbs.	851 81002 08
Phone Holder	Black	5 lbs.	851 81005 08
Pencil Holder	Black	4 lbs.	851 81000 08



### Manual Lift Table Base

320 lb. load rating, height range 29: to 46", width range 43" to 63".

Description	Color	Part Number
Manual Lift Table Base	White	769 10500 02
Manual Lift Table Base	Gray	769 10500 06
Manual Lift Table Base	Black	769 10500 08



### Single Motor Lift Table Base

380 lb. load rating, height range 29: to 46", width range 43" to 63".

Description	Color	Part Number
1 Motor Lift Table Base	White	769 11500 02
1 Motor Lift Table Base	Gray	769 11500 06
1 Motor Lift Table Base	Black	769 11500 08



### Two Motor Lift Table Base with Height Presets

480 lb. load rating, height range 29: to 46", width range 43" to 63".

Description	Color	Part Number
2 Motor Lift Table Base	White	769 12500 02
2 Motor Lift Table Base	Gray	769 12500 06
2 Motor Lift Table Base	Black	769 12500 08



### Two Motor Lift Table Base with Return lift and Height Presets

480 lb. load rating, height range 29: to 46", width range 43" to 63".

Description	Color	Part Number
2 Motor Lift Table Base	White	769 13500 02
2 Motor Lift Table Base	Gray	769 13500 06
2 Motor Lift Table Base	Black	769 13500 08

## Wire Clamping Plastic Grommet

Slot in the grommet grip wire in place.

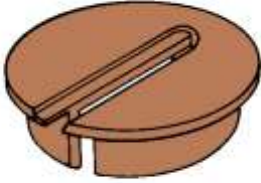

Description	Color	Part Number
1" Grommet	White	659 0400 02
1" Grommet	Brown	852 40400 05
1-1/8" Grommet long shank	White	71 SLI401 02
1-1/8" Grommet	White	71 00H401 02
1-1/8" Grommet	Oak	852 41401 04
1-1/8" Grommet	Brown	852 40401 05
1-1/8" Grommet	Tan	852 41401 06
1-1/8" Grommet	Almond	852 40100 06
1-1/8" Grommet	Black	852 40401 08

## Thin Material Plastic Grommet

Sleeve Only



Description	Color	Part Number
1-1/2" Plastic Grommet Sleeve for thin material	Brown	852 40414 05
1-1/2" Plastic Grommet Sleeve for thin material	Black	852 40414 08
1-3/4" Plastic Grommet Sleeve for thin material	Brown	852 40900 05
1-3/4" Plastic Grommet Sleeve for thin material	Black	852 40300 08

## Plastic Grommet

Sleeve Only



Description	Color	Part Number
1-3/4" Plastic Grommet Sleeve	White	852 40300 02
1-3/4" Plastic Grommet Sleeve	Brown	852 40300 05
1-3/4" Plastic Grommet Sleeve	Almond	852 40300 06
1-3/4" Plastic Grommet Sleeve	Black	852 40416085



## Two Piece Plastic Grommet

Grommet cap and sleeve.

Description	Color	Part Number
1-1/2" Plastic Grommet Cap with wire cut out	White	852 78500 02
1-1/2" Plastic Grommet Cap with wire cut out	Brown	852 78500 05
1-1/2" Plastic Grommet Cap with wire cut out	Almond	852 78500 06
1-1/2" Plastic Grommet Cap with wire cut out	Black	852 78500 08
2-1/2" Plastic Grommet 2 piece	White	852 40465 02
2-3/4" Plastic Grommet 2 piece	Brown	659 0238 08



## Oval Plastic Grommet

Grommet cap and sleeve.

Description	Color	Part Number
1-3/4" x 3-1/4" Plastic Grommet Sleeve	Black	852 03500 08
1-3/4" x 3-1/4" Plastic Grommet Cap	Black	852 03500 18
2-3/8" x 4-1/2" Plastic Grommet	Black	852 02900 08

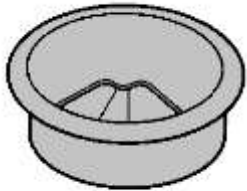

## 3 piece Plastic Grommet

Rotates to change opening size.

Description	Color	Part Number
50mm Plastic Grommet	Brown	852 40450 08
50mm Plastic Grommet	Black	852 40450 08
60mm Plastic Grommet	Brown	852 40460 05
60mm Plastic Grommet	Black	852 40460 08
80mm Plastic Grommet	Brown	852 40480 05
80mm Plastic Grommet	Almond	852 40480 06
80mm Plastic Grommet	Black	852 40480 08
80mm Gray Plastic Grommet	Light Gray	852 40480 15



## Flex Grommet

Rubber flexible top. Other sizes and colors available.

Description	Color	Part Number
Rectangular Letter Size Grommet	Brown	852 56312 05
60mm Plastic Flex Grommet	Black	852 40461 08
Oval Letter Size Grommet	Black	852 56312 08
Oval Computer Paper Size Grommet	Black	852 56317 08



## Plastic Paper Grommet

Description	Color	Part Number
Rectangular Letter Size Grommet	Brown	852 56312 05
60mm Plastic Flex Grommet	Black	852 40461 08
Oval Letter Size Grommet	Black	852 56312 08
Oval Computer Paper Size Grommet	Black	852 56317 08

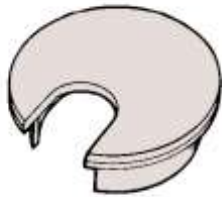

## Metal Grommet

Metal grommet is our best quality.

Description	Color	Part Number
40mm Brass Plated Grommet	Brass	852 18426 03
40mm Black Grommet	Black	852 18426 08
40mm Satin Nickel	Satin Nickel	196 11450 13

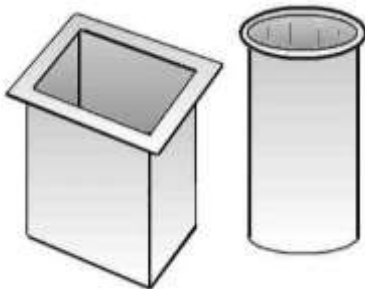

## Chrome Plated Steel Sleeves

Description	Color	Part Number
1 1/2" Dia. X 4" Steel Sleeve	Chrome	227 01500 02
2" Dia. X 4" Steel Sleeve	Chrome	227 02000 02
3" Dia. X 4" Steel Sleeve	Chrome	227 03000 02
12" Dia. X 4" Steel Sleeve	Chrome	227 12000 02



## CD or DVD Rack

Description	Color	Part Number
Flip and See CD or DVD Rack 2 per set	Black	850 0000 08
Flip and See CD or DVD Rack with end pieces	Black	850 02000 08

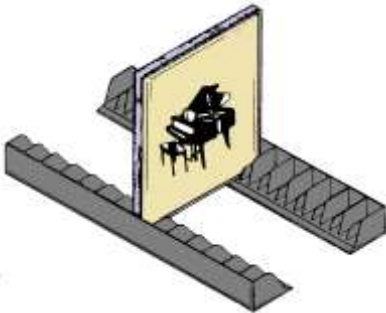

## Media Racks

Description	Color	Part Number
CD or DVD Tray	Black	850 01700 08
VCR Tray	Black	850 01600 08
Cassette Tray	Black	850 01500 08

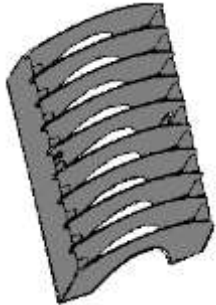

## Vertical CD / DVD Rack

Description	Color	Part Number
CD or DVD Rack	Black	850 04200 08



## Light Weight Shelf Bracket

Description	Color	Part Number
Shelf bracket	Black	850 04242 08

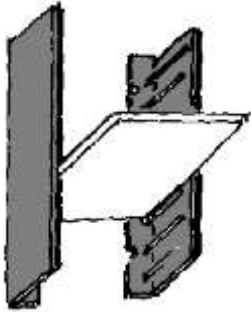

## CD / DVD Rack

Description	Color	Part Number
Angled CD / DVD Rack	Black	850 06020 08

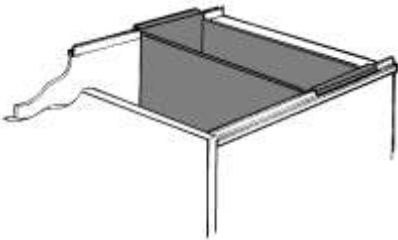

## Multi Media Bin

Great for desk drawers.

Description	Color	Part Number
12 3/4" x 5 3/4" x 5 1/2" Plastic bin	Black	850 53122 08

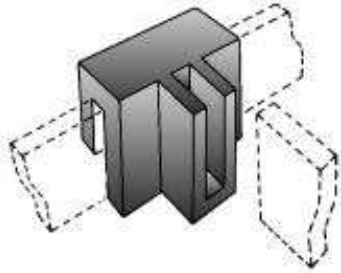

## Hanging File Bar Clips

Description	Color	Part Number
File Bar to File Bar clip	Black	851 09000 08

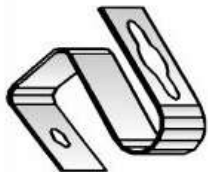

## Hanging File Bar Clips

Description	Color	Part Number
1/2" Thick drawer side clip rod or bar	Zinc	39 226
1/2" Thick drawer side clip rod only		509 12030 02



## Hanging File Bar

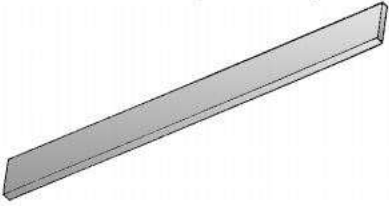

Description	Color	Part Number
1/8" x 1/2" 96" Aluminum bar for hanging files		509 89144 00

## Hanging File Extrusions

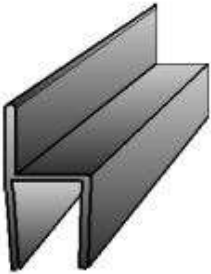

Description	Color	Part Number
1/2" Thick drawer side extrusion	Black	851 10460 08

## Hanging File Extrusions

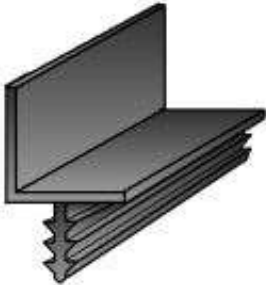

Description	Color	Part Number
1/2" Thick drawer side T-barb extrusion	Black	851 10506 08

## Locking Wire Management Extrusions

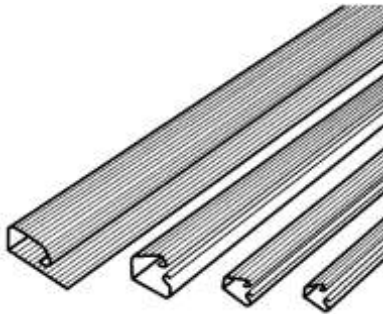

Description	Color	Part Number
3/4" x 1" Wire management clip with PSA tape	Black	851 50601 08
3/4" x 98" Wire management extrusion with PSA tape	Black	851 50698 08
1" x 98: Wire management extrusion with PSA tape	Black	851 50198 08
1 1/2" x 1" Wire management clip with PSA tape	Black	851 51401 08
1 1/2" x 98" Wire management extrusion with PSA tape	Black	851 51498 08

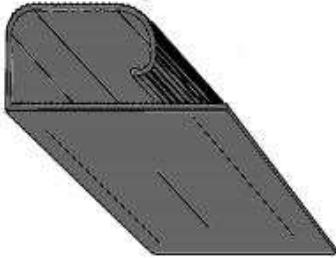

Description	Color	Part Number
2 3/8" x 1" Wire management clip with PSA tape	Black	851 32101 08
2 3/8" x 98" Wire management extrusion with PSA tape	Black	851 32198 08



## Drawer Divider Supports

Description	Color	Part Number
1/8" to 3/16" Molded slot divider	Beige	650 83190 06
1/4" to 5/16" Molded slot divider	Beige	650 83191 06
1/4" to 5/16" Molded tack nail divider	Beige	650 83189 06
1/4" to 5/16" Molded Staple divider	Beige	650 83789 06

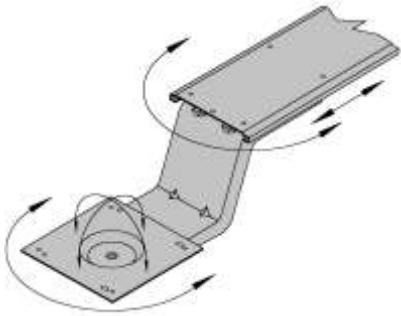

## Economy Keyboard Support

Without tray

Description	Color	Part Number
17 3/8" Track keyboard arm/support	Black	850 90500 08

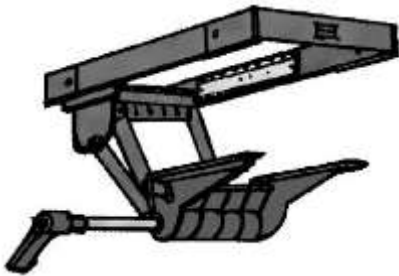

## Single Knob Keyboard Support

Ball bearing action with forward and backward tilt.

Description	Color	Part Number
17 3/8" Track keyboard arm/support	Black	850 95535 18

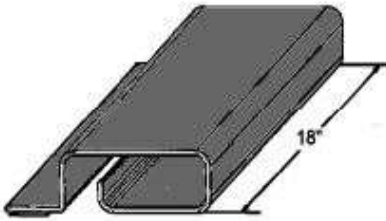

## Economy Wrist Rest

with PSA tape.

Description	Color	Part Number
18" Economy wrist rest	Black	851 25618 08

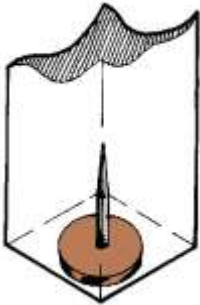

## Oval Tack Glides

Domed for easy sliding.

Description	Color	Part Number
33-73 Oval Tack Glide 5/8" dia. 3/16" thick	White	655 33073 02
33-73 Oval Tack Glide 5/8" dia. 3/16" thick	Beige	655 33073 06
33-74 Oval Tack Glide 3/4" dia. 3/16" thick	White	655 33074 02
33-74 Oval Tack Glide 3/4" dia. 3/16" thick	Beige	655 33074 06
33-75 Oval Tack Glide 7/8" dia. 3/16" thick	Beige	655 33075 06
33-79 Oval Tack Glide 7/8" dia. 3/16" thick	Beige	65 0802

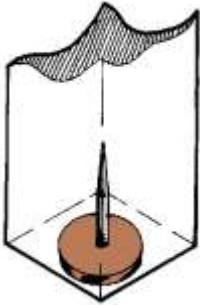

## Flat Tack glides

Flat base for maximum load bearing.

Description	Color	Part Number
33-91 Flat Tack Glide 5/8" dia. 1/4" thick	Beige	655 33091 06
33-2018 Flat Tack Glide 5/8" dia. 1/4" thick	Walnut	65 0980
33-19 Flat Tack Glide 3/4" dia. 3/16" thick	Beige	65 0705
33-92 Flat Tack Glide 3/4" dia. 1/4" thick	Beige	655 33092 06
33-93 Flat Tack Glide 7/8" dia. 1/4" thick	White	655 33093 02
33-93 Flat Tack Glide 7/8" dia. 1/4" thick	Beige	655 33093 06
33-94 Flat Tack Glide 1" dia. 1/4" thick	Beige	655 33094 06



## Metal Thumb Tack

Used most commonly with drawers.

Description	Color	Part Number
1/2 dia. Round Thumb Tack Nickel	Beige	650 33015 02

## Rectangular Tack Glide

Used most commonly with drawers.



Description	Color	Part Number
33-16 Beige Tack Glide 3/4" x 1/2" x .080 thick	Beige	650 33016 06
33-68 Beige Tack Glide 3/4" x 1/2" x .120 thick	Beige	650 33068 06

## Rectangular Tack Glide

Used most commonly with drawers.



Description	Color	Part Number
33-2101 Beige Tack Glide 1-1/4" x 1/2" x .080 thick	Beige	650 33210 06

## Dome Head Tack Glide



Description	Color	Part Number
34-106 Dome Head Tack Glide White 5/8" dia. 3/8" thick	White	655 34106 02

## Single Prong Metal Floor Glides

Economical floor glide.



Description	Color	Part Number
5/8" dia. Metal Floor glide Nickel	Nickel	655 40625 02

## Three Prong Floor Glide

Economical floor glide.



Description	Color	Part Number
5/8" Three Prong Floor Glide Zinc	Plain	655 50625 01

## Tack Glide with Serrated Nail



Description	Color	Part Number
33-8100 Flat Tack Glide Black 7/8" dia. 3/4" thick	Black	65 0989
33-6200 Flat Tack Glide 3/4" dia. 1/4" thick	Black	655 33620 08

## Two Nail Plastic Bumper Glides

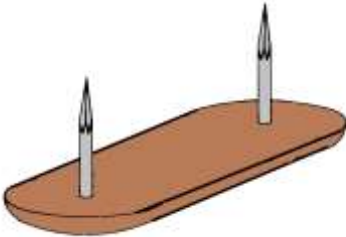

Description	Color	Part Number
34-105 Plastic Nail Bumper Glide 5/8" x 1-13/16" long	White	655 34105 02
34-105 Plastic Nail Bumper Glide 5/8" x 1-13/16" long	Brown	655 34105 05

## Edge Guard for Panel Bottom

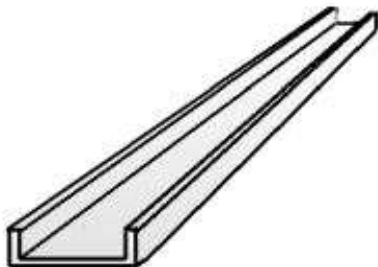

Description	Color	Part Number
3/4" x 96" edge guard	Clear	273 12434 00

## Hex Floor Glide

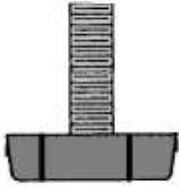

Description	Color	Part Number
33-6600 Hex Flat Base Floor Glide 5/16-18 x 1-1/2"	Black	655 33660 08

## Low Profile Base Floor Glide with Metal Shroud



Description	Color	Part Number
Low Profile Flat Base Floor Glide w/Metal Shroud 5/16-18 x 1" long	Nickel	655 33661 08

## Low Profile Base Floor Glides

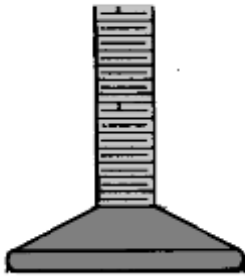

Description	Color	Part Number
33-355 Low Profile Floor Glide 1-1/2" dia. 1/4-20 x 1-1/2" long	Black	655 33355 08
33-122 Low Profile Floor Glide 1-1/2" dia. 5/16-18 x 1-1/2" long	Black	655 33122 08
33-6011 Low Profile Floor Glide 1-3/4" x 38-16 x 1-1/2" long	Black	655 33611 08
33-6010 Low Profile Floor Glide 2" dia. 3/8-16 x 1" long	Black	655 33610 08

## Floor Glides Self leveling



Description	Color	Part Number
33-134 Self Leveling Floor Glide 1-5/16" dia. 1/4-20 x 15/16" long	Beige	65 0900
27-160 Swivel Floor Glide 1-1/8" dia. Nail Type - No Bolt	Beige	65 0470

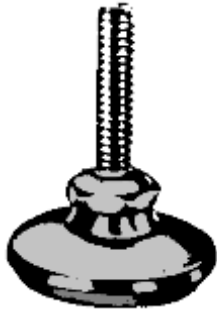

## Floor Glides Self leveling

Self leveling if leg or base is not straight.

Description	Color	Part Number
33-7500 Self Leveling Floor Glide Nickel 1-1/2" dia. 3/8-16 x 2" long	Nickel	655 33750 02
33-7510 Self Leveling Floor Glide Nickel 1-1/2" dia. 3/8-16 x 3" long	Nickel	655 33751 02
33-7520 Self Leveling Floor Glide Nickel 1-1/2" dia. 3/8-16 x 3-1/2" long	Nickel	655 33752 02
33-7540 Self Leveling Floor Glide Nickel 1-1/2" dia. 3/8-16 x 4" long	Nickel	655 33754 02

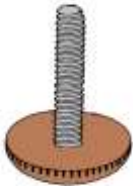

## Oval Base Floor Glides

Domed for easy sliding.

Description	Color	Part Number
33-124 Oval Floor Glide 5/8" dia. 1/4-20 x 1" long	White	655 33124 02
33-124 Oval Floor Glide 5/8" dia. 1/4-20 x 1" long	Beige	655 33124 06
33-356 Oval Floor Glide 5/8" dia. 1/4-20 x 5/8" long	Black	655 33356 08
33-131 Oval Floor Glide 7/8" dia. 1/4-20 x 1" long	Beige	655 33131 06
33-139 Oval Floor Glide 1-1/8" dia. 1/4-20 x 5/8" long	Beige	655 33139 02
33-139 Oval Floor Glide 1-1/8" dia. 1/4-20 x 5/8" long	Beige	655 33139 06



## Flat Base Floor Glides

For maximum load bearing.

Description	Color	Part Number
33-5340 Flat Floor Glide 7/8" dia. 5/16-18 x 1" long	Black	655 33534 08
33-5322 Flat Floor Glide w/ T-Nut 1" dia. 5/16-18 x 1" long	White	655 33532 06
33-6970 Flat Floor Glide 1" dia. 5/16-18 x 2-1/4" long	Beige	655 33697 02
33-6990 Flat Floor Glide 1" dia. 5/16-18 x 3-1/4" long	White	655 33699 02
33-7000 Flat Floor Glide 1" dia. 5/16-18 x 3-3/4" long	Beige	655 33700 06
33-7010 Flat Floor Glide 1" dia. 5/16-18 x 4-1/4" long	Beige	655 33701 06

## Floor Glides



Description	Color	Part Number
33-8100 Flat Floor Glide Plastic 1" dia. 1/4-20 x 3/4" long	Black	65 0989-1
33-8030 Flat Floor Glide Plastic 1" dia. 1/4-20 x 1/2" long	Black	65 0989-2

## Cushion Floor Glides

Rubber cushion to ease load.



Description	Color	Part Number
RG105 Metal base with Rubber Cushion 7/8" dia. 1/4-20 x 1/2" long	Nickel	655 33104 02
RG105 Metal base with Rubber Cushion 7/8" dia. 1/4-20 x 3/4" long	Nickel	655 33105 02
RG105 Metal base with Rubber Cushion 7/8" dia. 1/4-20 x 1-1/8" long	Nickel	655 33106 02
RG110 Metal base with Rubber Cushion 1-1/16" dia. with Nail	Nickel	655 61062 02

## Corner Brace for Floor Glides

Leveling Glide not Included.

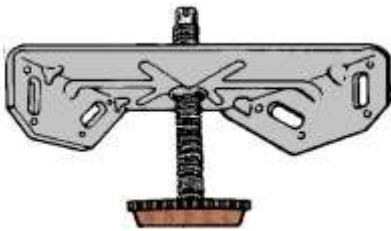

Description	Color	Part Number
Corner Brace 3/8-16 Thread 2-53/64" x 2-53/64"	Zinc	655 2375 00
Corner Brace 5/16-18 Thread 2-53/64" x 2-53/64"	Zinc	655 2375 10

## Support Bracket for Floor Glides

Leveling Glide not Included.



Description	Color	Part Number
Support Bracket 3/8-16 Thread	Zinc	655 91375 00
Support Bracket 5/16-18 Thread	Zinc	655 91312 02





## Heavy Duty Corner Brace and Glide

Description	Color	Part Number
7/8" x 7/8" x 1 3/4" x 2" diameter foot	Brown	659 01000 05

## Cam Locks



Description	Color	Part Number
19mm dia. 30mm long Cam Lock KA	Chrome	511 10300 06
Cam Lock only KA 2 Keys with Hex nut	Chrome	510 31103 02
Cam Lock with 2", 1/4" offset cam KA	Brass	510 31104 03
Cam Lock 1-1/2" long cam, 3/8" offset	Chrome	510 37861 02
Lock Stop Bracket	Plain Steel	510 00014 01
22mm Straight Cam for lock	Zinc	510 00022 02
38mm Straight Cam for Lock	Zinc	510 00038 02
2-3/16" Straight Cam for Lock	Zinc	510 00051 02
1-1/2" long 1/4" offset cam for lock	Zinc	510 02038 02

## Drawer Locks

### 1-1/8" Drawer Lock KA

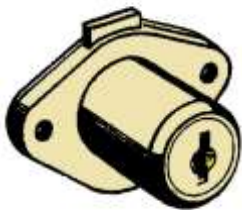

Description	Color	Part Number
1-1/8" Drawer Lock KA	Brass	510 98600 03



### 19mm dia. 22mm long Die cast Drawer Lock

Description	Color	Part Number
19mm dia. 22mm long Die cast Drawer Lock	Brass	511 13822 03
19mm dia. 22mm long Stamped Drawer Lock	Brass	511 13822 13
19mm dia. 22mm long Stamped Drawer Lock	Chrome	511 13822 06
19mm dia. 26mm long Die cast Drawer Lock	Brass	511 13826 03
19mm dia. 26mm long Die cast Drawer Lock	Chrome	511 13826 06
19mm dia. 26mm long Die cast Drawer Lock	Black	511 13826 08
22mm dia. Drawer Lock	Brass	511 80100 03



### Double Drawer Lock

Double Drawer Lock with 20 different combos

Description	Color	Part Number
Double Drawer Lock with 20 different combos	Brass	510 97001 03
Collar for Drawer Lock	Brass	510 97101 03

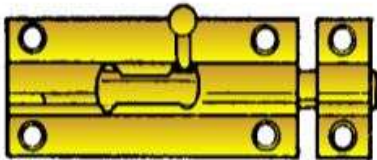

### Barrel Bolts

2" Barrel Bolt

Description	Color	Part Number
2" Barrel Bolt	Zinc	510 41302 02
2" Barrel Bolt	Brass	510 41302 03
4" Barrel Bolt	Brass	510 41402 03

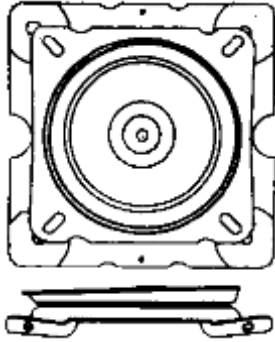

## Direct Mount Bar Stool Swivel

Legs mount directly to the swivel

Description	Finish	Part Number
Direct Mount Swivel 12BB Flat	Plain	721 04120 01
Direct Mount Swivel 12BB 3 degree	Plain	721 04123 01

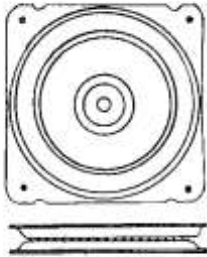

## Heavy Duty Swivel

Strong enough for chairs and stools.

Description	Finish	Part Number
7" Flat Swivel All BB	Plain	721 07070 07

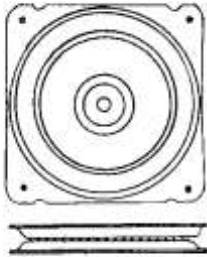

## Heavy Duty Return Swivel

Strong enough for chairs and stools.

Description	Finish	Part Number
8" Flat Memory Return Swivel 8BB	Plain	721 17070 01

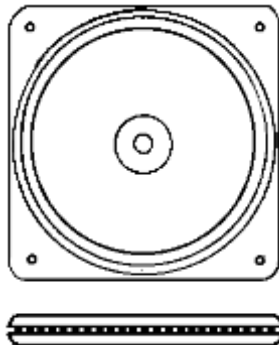

## Heavy Duty Large Swivel

Large size where extra stability is needed.

Description	Finish	Part Number
10 1/4" Flat Heavy Duty Swivel	Plain	721 11110 01

## Bar Stool Foot Ring

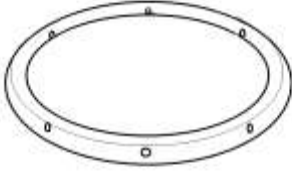

Description	Finish	Part Number
16 3/4" Steel Foot ring	Brass	721 16750 03

## Swivel Support

Ball bearing supports extra large swivel applications.



Description	Finish	Part Number
Plastic Knock in BB Housing 3/8"	Black	721 99000 01

## Swivel Support

Roller supports extra large swivel applications.



Description	Finish	Part Number
Swivel roller with 32mm centers	Stat Bronze	721 99900 01

## Swivel with Pre-mounted Legs



Description	Finish	Part Number
Deluxe Swivel with legs	Brown	722 10110 01

## Lazy Susan Swivels

Low profile free rotating swivel bearings.



Description	Finish	Part Number
4" Square Lazy Susan Swivel	Plain	685 00400 08
6" Square Lazy Susan Swivel	Plain	685 00600 01



Description	Finish	Part Number
9" Round Lazy Susan Swivel	Plain	685 00900 08
12" Round Lazy Susan Swivel	Plain	685 02400 08



## Table Top Pop Mechanism

Lifts entire or section of table top for dining or a stand desk.

Description	Finish	Part Number
Pop Up Mechanism S33 Springs	Black	722 87000 08
Pop Up Mechanism S24 Springs	Black	722 87000 18
S22 Spring For Pop Up Mechanism	Black	722 87022 08
S24 Spring For Pop Up Mechanism	Black	722 87024 08
S33 Spring For Pop Up Mechanism	Black	722 87033 08