

## Sit/Stand Desk Bases

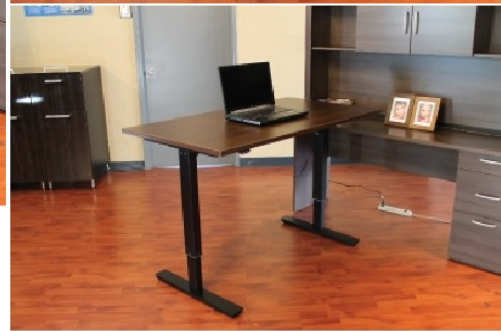
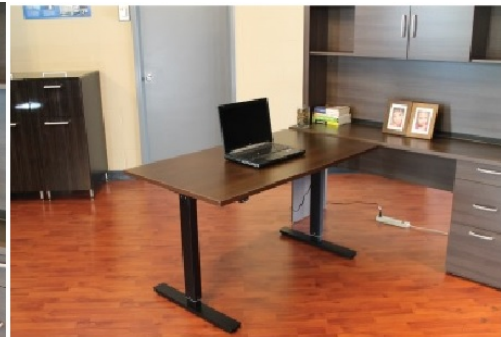

Available with manual or electric motor models with memory settings for different heights.

Having the possibility to work in a sitting or standing position has many health benefits. These include promoting better circulation, better breathing, better digestion, as well as keeping the mind focused and relieving back pain. These are only some of the advantages of having the choice of having a flexible workspace. This lift table a great option for residential as well as office use.

See page two for product information.



## Manual Lift Table Base

Part Number	Description	Finish
769 10500 02	Manual Lift Table Base	White
769 10500 06	Manual Lift Table Base	Gray
769 10500 08	Manual Lift Table Base	Black

320 lb. load rating, height range 29" to 46", width range 43" to 63".



## Single Motor Lift Table Base

Part Number	Description	Finish
769 11500 02	1 Motor Lift Table Base	White
769 11500 06	1 Motor Lift Table Base	Gray

380 lb. load rating, height range 29" to 46", width range 43" to 63".



## Two Motor Lift Table Base with Height Presets

Part Number	Description	Finish
769 12500 02	2 Motor Lift Table Base	White
769 12500 06	2 Motor Lift Table Base	Gray

480 lb. load rating, height range 29" to 46", width range 43" to 63".



## Flip Top Aluminum Grommet

Part Number	Description	Finish
852 080080 02	80mm x 80mm Square Aluminum Grommet	Satin Aluminum
852 080150 02	80mm x 150mm Rectangular Aluminum Grommet	Satin Aluminum
852 080270 02	80mm x 270mm Rectangular Aluminum Grommet	Satin Aluminum

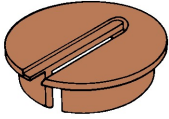

Part Number	Description	Finish
852 40401 05	1-1/8" Grommet	Brown
852 41401 06	1-1/8" Grommet	Tan
852 40401 08	1-1/8" Grommet	Black



Sleeve Only

## Thin Material Plastic Grommet

Part Number	Description	Finish
852 40300 08	1-3/4" Plastic Grommet Sleeve for 1/4" material	Black



Sleeve Only

## Plastic Grommet

Part Number	Description	Finish
852 40416085	1-3/4" Plastic Grommet Sleeve for 3/4" Material	Black



Grommet cap and sleeve.

## Two Piece Plastic Grommet

Part Number	Description	Finish
852 78500 02	1-1/2" Plastic Grommet Cap with wire cut out	White
852 78500 08	1-1/2" Plastic Grommet Cap with wire cut out	Black
852 40465 08	2-1/2" Plastic Grommet 2 piece	Black

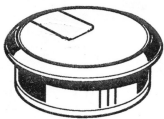

## Lift Lid Grommet

Part Number	Description	Finish
659 0238 08	2-3/4" Plastic Grommet 2 piece	Brown

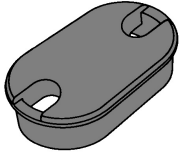

## Oval Plastic Grommet

Part Number	Description	Finish
852 03500 08	1-3/4" x 3-1/4" Plastic Grommet Sleeve	Black
852 03500 18	1-3/4" x 3-1/4" Plastic Grommet Cap	Black

Grommet cap and sleeve.

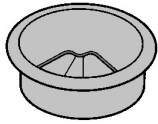

## 3 piece Plastic Grommet

Part Number	Description	Finish
852 40450 08	50mm Plastic Grommet	Brown
852 40450 08	50mm Plastic Grommet	Black
852 40460 05	60mm Plastic Grommet	Brown
852 40460 08	60mm Plastic Grommet	Black
852 40480 05	80mm Plastic Grommet	Brown
852 40480 06	80mm Plastic Grommet	Almond
852 40480 08	80mm Plastic Grommet	Black
852 40480 15	80mm Gray Plastic Grommet	Light Gray

Rotates to change opening size.



## Flex Grommet

Part Number	Description	Finish
852 40461 08	60mm Plastic Flex Grommet	Black

Rubber flexible top. Other sizes and colors available.

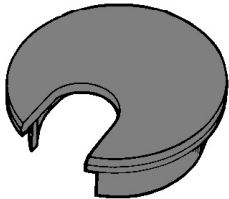

## Metal Grommet

Part Number	Description	Finish
852 18426 08	40mm Black Grommet	Black
196 11450 13	40mm Satin Nickel	Satin Nickel



## Chrome Plated Steel Sleeves

Part Number	Description	Finish
227 01500 02	1 1/2" Dia. X 4" Steel Sleeve	Chrome
227 02000 02	2" Dia. X 4" Steel Sleeve	Chrome
227 03000 02	3" Dia. X 4" Steel Sleeve	Chrome
227 12000 02	12" Dia. X 4" Steel Sleeve	Chrome

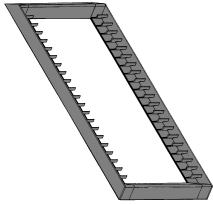

## CD or DVD Rack

Part Number	Description	Finish
850 01000 08	Flip and See CD or DVD Rack 2 per set	Black
850 02000 08	Flip and See CD or DVD Rack with end pieces	Black

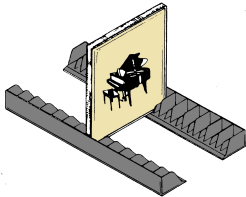

## Media Racks

Part Number	Description	Finish
850 01700 08	CD or DVD Tray	Black
850 01600 08	VCR Tray	Black
850 01500 08	Cassette Tray	Black

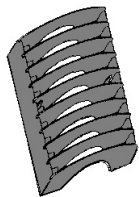

## Vertical CD / DVD Rack

Part Number	Description	Finish
850 04200 08	CD or DVD Rack	Black

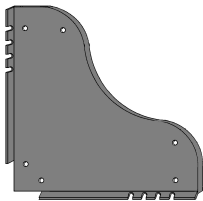

## Light Weight Shelf Bracket

Part Number	Description	Finish
850 04242 08	Shelf bracket	Black

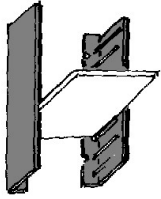

## CD / DVD Rack

Part Number	Description	Finish
850 06020 08	Angled CD / DVD Rack	Black

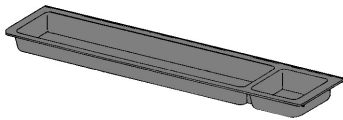

## Pencil Tray

Part Number	Description	Finish
65 0118	3" X 12 5/8" Black Pencil Tray	Black

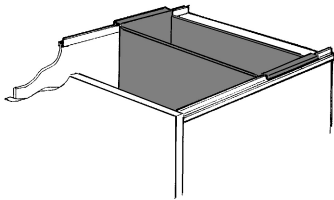

## Multi Media Bin

Part Number	Description	Finish
850 53122 08	12 3/4" x 5 3/4" x 5 1/2" Plastic bin	Black

Great for desk drawers.

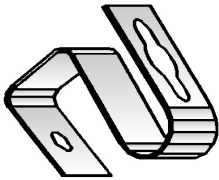

## Hanging File Bar Clips

Part Number	Description	Finish
39 226	1/2" Thick drawer side clip rod or bar	Zinc

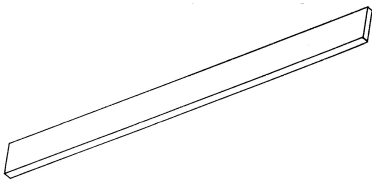

## Hanging File Bar

Part Number	Description	Finish
509 89144 00	1/8" x 1/2" 96" Aluminum bar for hanging files	

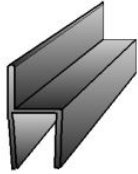

## Hanging File Extrusions

Part Number	Description	Finish
851 10406 08	1/2" Thick drawer side extrusion	Black

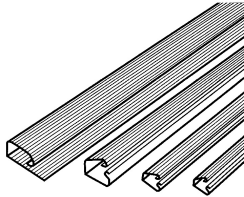

## Locking Wire Management Extrusions

Part Number	Description	Finish
851 50601 08	3/4" x 1" Wire management clip with PSA tape	Black
851 50698 08	3/4" x 98" Wire management extrusion with PSA tape	Black
851 50198 08	1" x 98: Wire management extrusion with PSA tape	Black
851 51401 08	1 1/2" x 1" Wire management clip with PSA tape	Black
851 51498 08	1 1/2" x 98" Wire management extrusion with PSA tape	Black

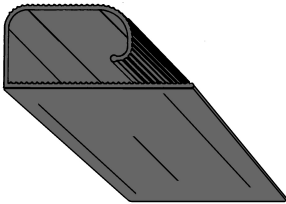

Part Number	Description	Finish
851 32101 08	2 3/8" x 1" Wire management clip with PSA tape	Black
851 32198 08	2 3/8" x 98" Wire management extrusion with PSA tape	Black



## Drawer Divider Supports

Part Number	Description	Finish
650 83190 06	1/8" to 3/16" Molded slot divider	Beige
650 83191 06	1/4" to 5/16" Molded slot divider	Beige
650 83189 06	1/4" to 5/16" Molded tack nail divider	Beige
650 83789 06	1/4" to 5/16" Molded Staple divider	Beige

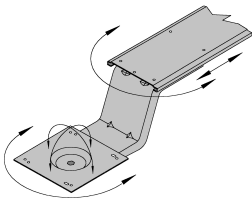

Without tray

## Economy Keyboard Support

Part Number	Description	Finish
850 90500 08	17 3/8" Track keyboard arm/support	Black

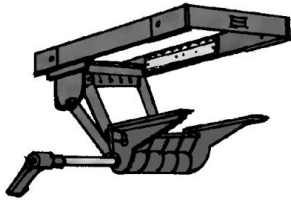

## Single Knob Keyboard Support

Part Number	Description	Finish
850 95535 18	17 3/8" Track keyboard arm/support	Black

Ball bearing action with forward and backward tilt.

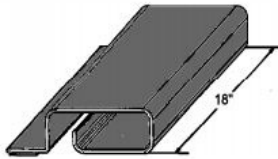

## Economy Wrist Rest

Part Number	Description	Finish
851 25618 08	18" Economy wrist rest	Black

with PSA tape.

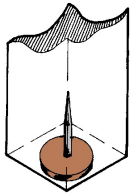

Domed for easy sliding.

## Oval Tack Glides

Part Number	Description	Finish
655 33073 02	33-73 Oval Tack Glide 5/8" dia. 3/16" thick	White
655 33073 06	33-73 Oval Tack Glide 5/8" dia. 3/16" thick	Beige
655 33074 02	33-74 Oval Tack Glide 3/4" dia. 3/16" thick	White
655 33074 06	33-74 Oval Tack Glide 3/4" dia. 3/16" thick	Beige
655 33075 06	33-75 Oval Tack Glide 7/8" dia. 3/16" thick	Beige
65 0802	33-79 Oval Tack Glide 7/8" dia. 3/16" thick	Beige
655 33091 06	33-91 Flat Tack Glide 5/8" dia. 1/4" thick	Beige
65 0980	33-2018 Flat Tack Glide 5/8" dia. 1/4" thick	Walnut
65 0705	33-19 Flat Tack Glide 3/4" dia. 3/16" thick	Beige
655 33092 06	33-92 Flat Tack Glide 3/4" dia. 1/4" thick	Beige
655 33093 02	33-93 Flat Tack Glide 7/8" dia. 1/4" thick	White
655 33093 06	33-93 Flat Tack Glide 7/8" dia. 1/4" thick	Beige
655 33094 06	33-94 Flat Tack Glide 1" dia. 1/4" thick	Beige



## Metal Thumb Tack

Part Number	Description	Finish
650 33015 02	1/2 dia. Round Thumb Tack Nickel	Beige

Used most commonly with drawers.



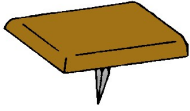

## Rectangular Tack Glide

Part Number	Description	Finish
650 33016 06	33-16 Beige Tack Glide 3/4" x 1/2" x .080 thick	Beige
650 33068 06	33-68 Beige Tack Glide 3/4" x 1/2" x .120 thick	Beige

Used most commonly with drawers.

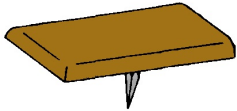

## Rectangular Tack Glide

Part Number	Description	Finish
650 33210 06	33-2101 Beige Tack Glide 1-1/4" x 1/2" x .080 thick	Beige

Used most commonly with drawers.

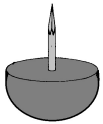

## Dome Head Tack Glide

Part Number	Description	Finish
655 34106 02	34-106 Dome Head Tack Glide White 5/8" dia. 3/8" thick	White



## Single Prong Metal Floor Glides

Part Number	Description	Finish
655 40625 02	5/8" dia. Metal Floor glide Nickel	Nickel

Economical floor glide.



## Three Prong Floor Glide

Part Number	Description	Finish
655 50625 01	5/8" Three Prong Floor Glide Zinc	Plain

Economical floor glide.



## Tack Glide with Serrated Nail

Part Number	Description	Finish
65 0989	33-8100 Flat Tack Glide Black 7/8" dia. 3/4" thick	Black

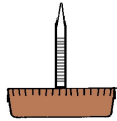

## Tack Glide with Serrated Nail

Part Number	Description	Finish
655 33620 08	33-6200 Flat Tack Glide 3/4" dia. 1/4" thick	Black

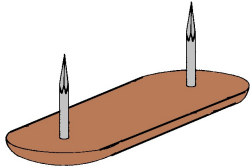

## Two Nail Plastic Bumper Glides

Part Number	Description	Finish
655 34105 02	34-105 Plastic Nail Bumper Glide 5/8" x 1-13/16" long	White
655 34105 05	34-105 Plastic Nail Bumper Glide 5/8" x 1-13/16" long	Brown

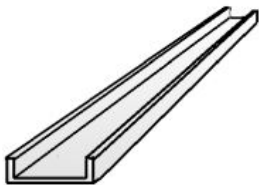

## Edge Guard for Panel Bottom

Part Number	Description	Finish
273 12434 00	3/4" x 96" edge guard	Clear

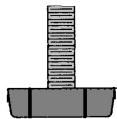

## Hex Floor Glide

Part Number	Description	Finish
655 33660 08	33-6600 Hex Flat Base Floor Glide 5/16-18 x 1-1/2"	Black

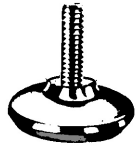

## Low Profile Base Floor Glide with Metal Shroud

Part Number	Description	Finish
655 33661 08	Low Profile Flat Base Floor Glide w/Metal Shroud 5/16-18 x 1" long	Nickel

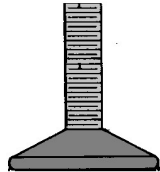

## Low Profile Base Floor Glides

Part Number	Description	Finish
655 33355 08	33-355 Low Profile Floor Glide 1-1/2" dia. 1/4-20 x 1-1/2" long	Black
655 33122 08	33-122 Low Profile Floor Glide 1-1/2" dia. 5/16-18 x 1-1/2" long	Black
655 33611 08	33-6011 Low Profile Floor Glide 1-3/4" x 38-16 x 1-1/2" long	Black
655 33610 08	33-6010 Low Profile Floor Glide 2" dia. 3/8-16 x 1" long	Black



## Floor Glides Self leveling

Part Number	Description	Finish
65 0900	33-134 Self Leveling Floor Glide 1-5/16" dia. 1/4-20 x 15/16" long	Beige
65 0470	27-160 Swivel Floor Glide 1-1/8" dia. Nail Type - No Bolt	Beige

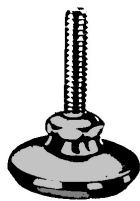

## Floor Glides Self leveling

Part Number	Description	Finish
655 33750 02	33-7500 Self Leveling Floor Glide Nickel 1-1/2" dia. 3/8-16 x 2" long	Nickel
655 33751 02	33-7510 Self Leveling Floor Glide Nickel 1-1/2" dia. 3/8-16 x 3" long	Nickel
655 33752 02	33-7520 Self Leveling Floor Glide Nickel 1-1/2" dia. 3/8-16 x 3-1/2" long	Nickel
655 33754 02	33-7540 Self Leveling Floor Glide Nickel 1-1/2" dia. 3/8-16 x 4" long	Nickel

Self leveling if leg or base is not straight.

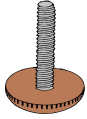

Domed for easy sliding.

## Oval Base Floor Glides

Part Number	Description	Finish
655 33124 02	33-124 Oval Floor Glide 5/8" dia. 1/4-20 x 1" long	White
655 33124 06	33-124 Oval Floor Glide 5/8" dia. 1/4-20 x 1" long	Beige
655 33356 08	33-356 Oval Floor Glide 5/8" dia. 1/4-20 x 5/8" long	Black
655 33131 06	33-131 Oval Floor Glide 7/8" dia. 1/4-20 x 1" long	Beige
655 33139 02	33-139 Oval Floor Glide 1-1/8" dia. 1/4-20 x 5/8" long	Beige
655 33139 06	33-139 Oval Floor Glide 1-1/8" dia. 1/4-20 x 5/8" long	Beige

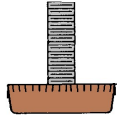

For maximum load bearing.

## Flat Base Floor Glides

Part Number	Description	Finish
655 33534 08	33-5340 Flat Floor Glide 7/8" dia. 5/16-18 x 1" long	Black
655 33532 06	33-5322 Flat Floor Glide w/ T-Nut 1" dia. 5/16-18 x 1" long	White
655 33697 02	33-6970 Flat Floor Glide 1" dia. 5/16-18 x 2-1/4" long	Beige
655 33699 02	33-6990 Flat Floor Glide 1" dia. 5/16-18 x 3-1/4" long	White
655 33700 06	33-7000 Flat Floor Glide 1" dia. 5/16-18 x 3-3/4" long	Beige
655 33701 06	33-7010 Flat Floor Glide 1" dia. 5/16-18 x 4-1/4" long	Beige

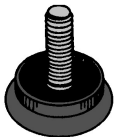

## Floor Glides

Part Number	Description	Finish
65 0989-1	33-8100 Flat Floor Glide Plastic 1" dia. 1/4-20 x 3/4" long	Black
65 0989-2	33-8030 Flat Floor Glide Plastic 1" dia. 1/4-20 x 1/2" long	Black

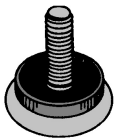

Rubber cushion to ease load.

## Cushion Floor Glides

Part Number	Description	Finish
655 33104 02	RG105 Metal base with Rubber Cushion 7/8" dia. 1/4-20 x 1/2" long	Nickel
655 33105 02	RG105 Metal base with Rubber Cushion 7/8" dia. 1/4-20 x 3/4" long	Nickel
655 33106 02	RG105 Metal base with Rubber Cushion 7/8" dia. 1/4-20 x 1-1/8" long	Nickel
655 61062 02	RG110 Metal base with Rubber Cushion 1-1/16" dia. with Nail	Nickel

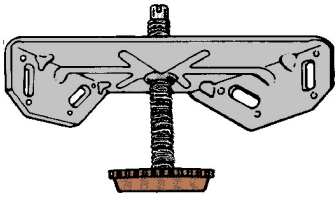

Leveling Glide not Included.

## Corner Brace for Floor Glides

Part Number	Description	Finish
655 2375 00	Corner Brace 3/8-16 Thread 2-53/64" x 2-53/64"	Zinc
655 2375 10	Corner Brace 5/16-18 Thread 2-53/64" x 2-53/64"	Zinc

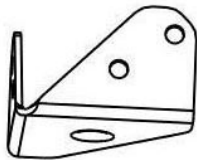

## Corner Brace for Floor Glides

Part Number	Description	Finish
532 01420 00	Corner Bracket for 1/4"-20 Floor Glide	Plain Steel

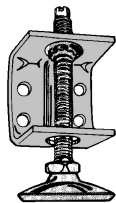

Leveling Glide not Included.

## Support Bracket for Floor Glides

Part Number	Description	Finish
655 91375 00	Support Bracket 3/8-16 Thread	Zinc
655 91312 02	Support Bracket 5/16-18 Thread	Zinc



## Cam Locks

Part Number	Description	Finish
511 10300 06	19mm dia. 30mm long Cam Lock KA	Chrome
510 31103 02	Cam Lock only KA 2 Keys with Hex nut	Chrome
510 31104 03	Cam Lock with 2", 1/4" offset cam KA	Brass
510 37861 02	Cam Lock 1-1/2" long cam, 3/8" offset	Chrome
510 00014 01	Lock Stop Bracket	Plain Steel
510 00022 02	22mm Straight Cam for lock	Zinc
510 00038 02	38mm Straight Cam for Lock	Zinc
510 00051 02	2-3/16" Straight Cam for Lock	Zinc
510 02038 02	1-1/2" long 1/4" offset cam for lock	Zinc

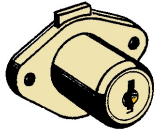

## Drawer Locks

Part Number	Description	Finish
510 98600 03	1-1/8" Drawer Lock KA	Brass

1-1/8" Drawer Lock KA



19mm dia. 22mm long Die cast Drawer Lock

Part Number	Description	Finish
511 13822 03	19mm dia. 22mm long Die cast Drawer Lock	Brass
511 13822 13	19mm dia. 22mm long Stamped Drawer Lock	Brass
511 13822 06	19mm dia. 22mm long Stamped Drawer Lock	Chrome
511 13826 03	19mm dia. 26mm long Die cast Drawer Lock	Brass
511 13826 06	19mm dia. 26mm long Die cast Drawer Lock	Chrome
511 13826 08	19mm dia. 26mm long Die cast Drawer Lock	Black
511 80100 03	22mm dia. Drawer Lock	Brass

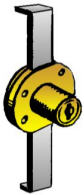

Double Drawer Lock with 20 different combos

## Double Drawer Lock

Part Number	Description	Finish
510 97001 03	Double Drawer Lock with 20 different combos	Brass
510 97101 03	Collar for Drawer Lock	Brass